

Technical Data

Additional equipments and options

Noise damping/safety device
 Gatefold device with 'X' knife unit
 (only if 44 'X' configuration)
 Gatefold device with gatefold plate
 Double stream device
 Small signature folder KFW 26/4
 Small sheet size delivery KAS 30
 Gully cut device
 Edge trim device
 Punch perforating device
 Multiple perforating device

Quantity of buckle plates at each folding unit

4 buckle plates

Drive/Speed

Drive with mechanical control
 160-8000 inch per min.

Size of feeder **B20**

Pile feeder
 minimum 4 x 6"
 maximum 20 x 28"

Continuous feeder
 minimum 4 x 6"
 maximum 20 x 36"

Working widths **B20**

folding unit I 20"
 Folding unit II 20"
 'X' knife unit 20"

Min. length of fold **B20**

1 1/4"

Max. length of fold **B20**

Folding unit I
 Buckle plate 1 and 2 18"
 Buckle plate 3 and 4 13 1/2"

Folding unit II
 Buckle plate 1-4 13 1/2"

Power requirements

Model
 B20/4 2.75 kW each
 B20/4X 2.75 kW each
 B20/44 3.10 kW each
 B20/44X 3.10 kW each
 B20/444 3.75 kW each

Technical illustrations reserved



Headquarters/400 Highland Drive
 Westampton, NJ 08060
 609 267 2900

Sheet size is not a question of infeed width.

Ongoing technical innovation and construction to the highest quality standards has made us what we are today, one of the worldwide leading manufacturers of large-size sheet folding machines. It was our objective to integrate the highly developed techniques, electronics and benefits of our 'big' machines into a new smaller machine. This has now been fulfilled with the new B20 model.

Highest precision and operational economics through a superior system.

The advantages of easily-removable knife shafts plus precise spiral foldrollers coupled with the maintenance-free and extremely quiet running belt drive system is offered to you by only one manufacturer – MBO.

The technical superiority of the MBO system is expressed in complete flexibility of usage with the shortest make-ready times even when a total changeover is required. Last but not least, by the new mobile and flexible 'X' knife folding unit. Just like all MBO machines, the B20 provides the best folding quality at the highest production capacities.

Model variants in cm (inches)

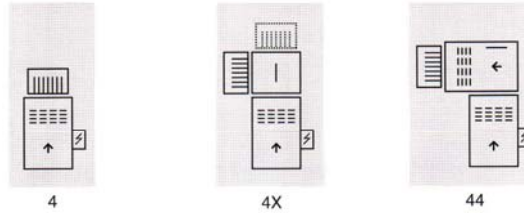

4

4X

44

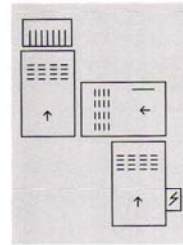

444

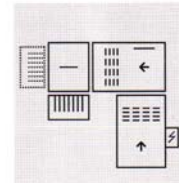

44X

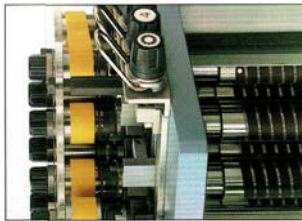

Standard: Spiral foldrollers

Famous for their tough grip, extremely quiet, no markings on sensitive papers, MBO quick-setting elements.

Belt drive system
(in the entire machine)

Proven system, has been applied to almost 100,000 units over 20 years. Extremely quiet running, maintenance free and long life.



Standard: Main control panel

MS control with integrated batch counter. Automatic setting of sheet gap.

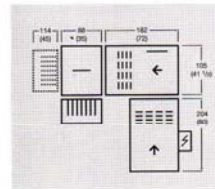

B20/44X



B20
Continuous Feeder



MBO

An absolute significance at small sizes.